

MiniFinder® Atto Pro

User manual

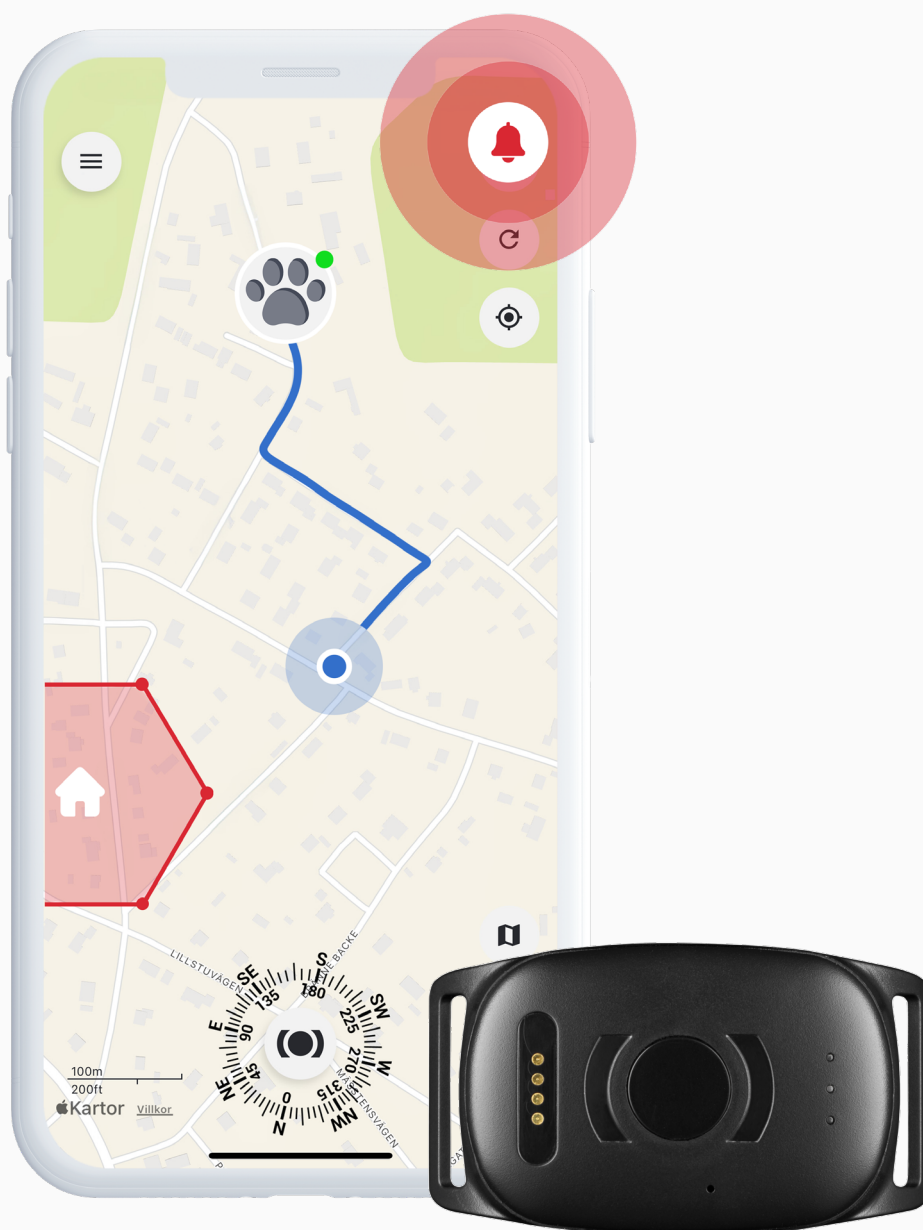

Package Contents

1 MiniFinder Atto Pro

2 Magnetic Charging Cable

3 Power Adapter

1



2



3



Product Management

- A** Charge your device for **3 hours** before using for the first time.
- B** When charging, the red LED blinks slowly every 3 seconds. When the battery is fully charged, the red LED shows solid light glows.
- C** Start the unit: Press and hold the On/Off button for **3 seconds** until it vibrates.
- D** Turn off the unit: Press and hold the On/Off button for **10 seconds** until it vibrates.
- E** When the unit does not detect movement, it activates the energy saving mode. When it detects movement, the unit wakes up automatically from the energy saving mode.

Charge the device with the supplied magnetic charger attached to the charging pins. Connect the USB cable to your computer or charge it through a USB power adapter.

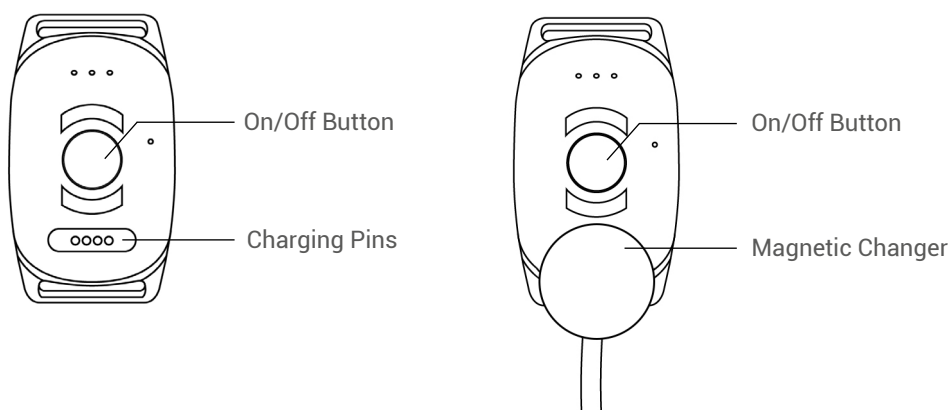

Explanation of LED Lights

GREEN LED:

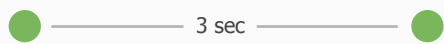

Single blink = Seasing GSM network

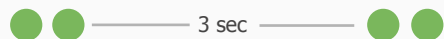

Double blink = Connected to GSM network

RED LED:

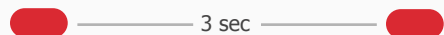

Slow blink = Charging



Steady blink = Fully charged

BLUE LED:

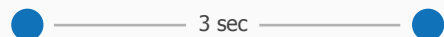

Slow blink = Searching for GPS signal



Double blink = Connected to satellite

Getting Started – Download the MiniFinder Live App

To begin using your **MiniFinder Atto Pro**, you first need to download the **MiniFinder Live App**.

If you're viewing this guide on your mobile device, simply click the Google Play or App Store icons to go directly to the download page. Alternatively, open the App Store or Google Play, and search for "MiniFinder Live" to install the app manually.



MiniFinder Live Introduction

Welcome to **MiniFinder Live**, a system designed to provide real-time positioning, smart alerts, and valuable insights to enhance safety and efficiency. Paired with the **MiniFinder Atto Pro**, this platform gives you access to real-time location tracking, smart notifications, and valuable insights to monitor your dog, cat or other animals – no matter where they roam.

This manual provides step-by-step guidance on how to use MiniFinder Live effectively. Follow the instructions to get started and make the most of your tracking experience.

App Overview

Once the app is installed, the first step is to create an account. Click **Sign Up**, then enter your email address and create a password to get started.

Once logged in, you will be presented with an app overview, which is displayed on the right-hand side of your screen.



Menu

To open the **quick menu**, click the white MiniFinder button. This gives you fast access to key features like Tags, Geofence, and the Scanner tool.

For additional options, use the **main menu** located in the top left corner of the screen.

By clicking this menu, you can access your profile, devices, contacts, reminders, and more.

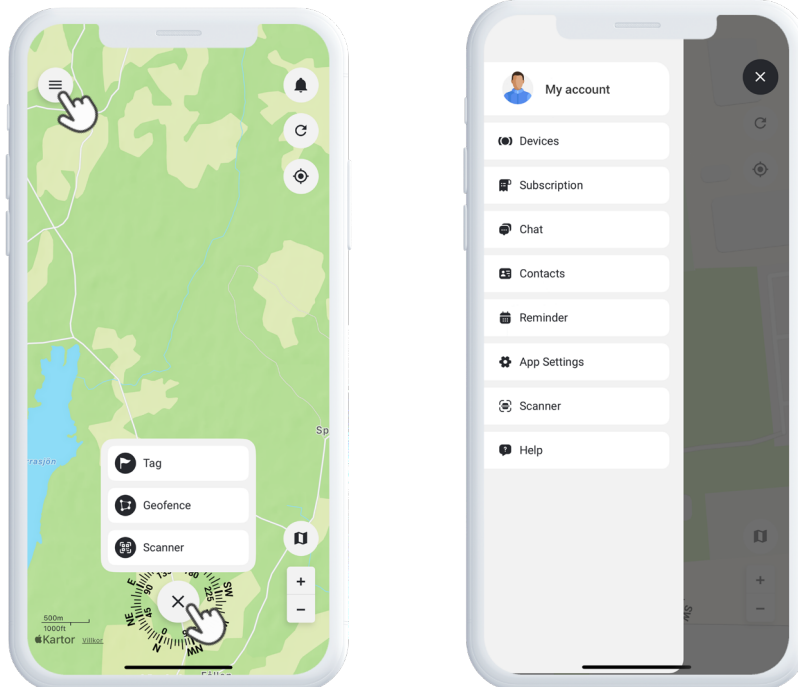

Add a New Device

To add a new device to your account, navigate to the **menu** located in the top left corner of the screen and select **Devices**. From there, click on the **plus sign**. You will now have the option to scan the barcode on your MiniFinder package to automatically populate the IMEI number. Alternatively, if the package is not available, you can manually input the IMEI number.

Next, you can choose a name for you device, update the profile picture, and select a color. Once you have completed these steps, simply click **Add device**.



Choose a subscription

You will now automatically be redirected to the subscription selection page. Choose the subscription plan that best suits your needs and follow the steps to complete the purchase.

Device List

You can now find your device in the Device List, located under **Devices** in the main menu.

By expanding the drop-down menu on your device (click the arrow on the right), you'll access several options, including:

- 1 **Show on Map** – View your device's current location
- 2 **Device Settings** – Adjust tracking and alert preferences
- 3 **Profile** – Edit device information
- 4 **Log** – View event history
- 5 **Comments** – Add notes related to the device

These tools help you manage and monitor your device with ease.

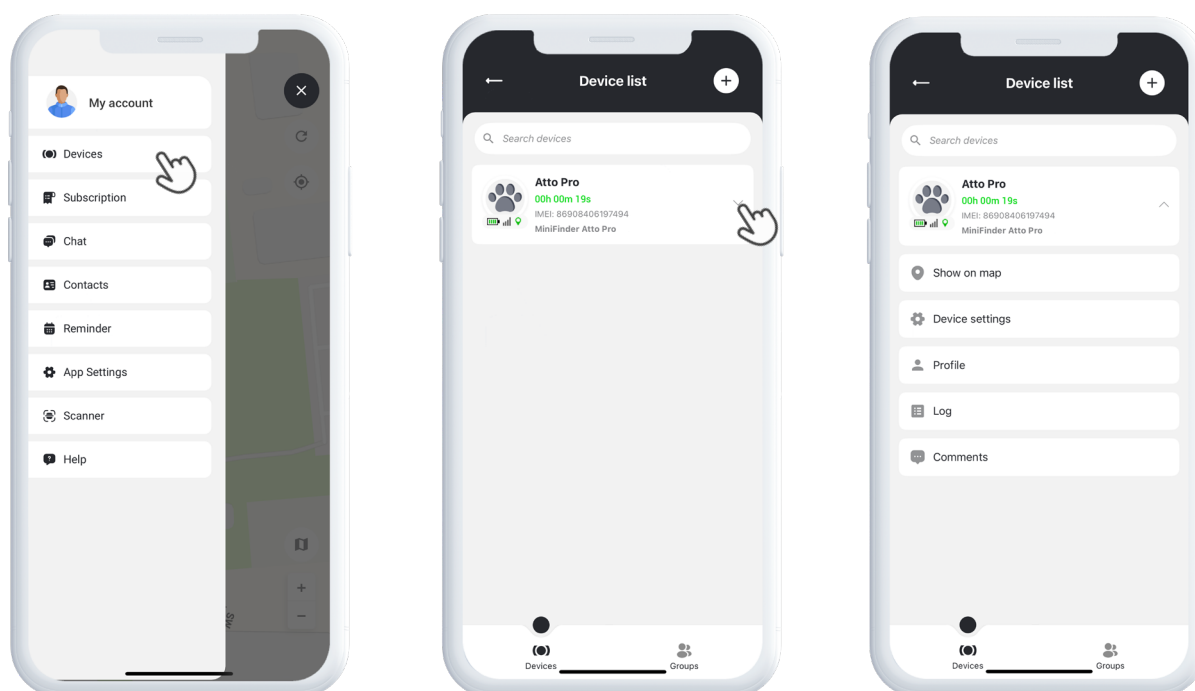

Device Panel

The Device Panel provides valuable insights into your device's location history and movement patterns, giving you a clearer picture of your animal's activity over time.

To access the Device Panel, simply click on your **device's icon** directly on the map. This opens a detailed view with tracking data such as recent routes, timestamps, and other key metrics.

From the panel, you can also:

- 1 Share live location
- 2 View historical data
- 3 Enable or customize trails
- 4 Set up alerts, such as speed alarms or low battery warnings

This makes it easy to monitor your animal's safety and behavior in real time.

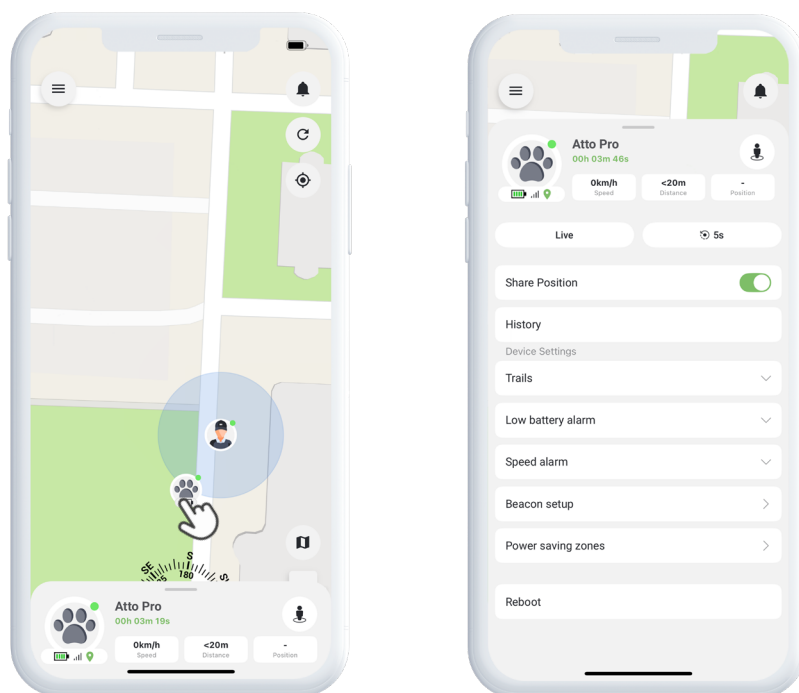

Device Settings

By clicking on **Settings** within the Device Panel, you'll be taken to a dedicated page where you can fine-tune various features and preferences. From adjusting update intervals to configuring alerts and notifications, this section allows you to optimize your device's performance to suit your specific tracking needs.

Alarm Notifications

To access your alarm notifications, click the blinking bell icon located in the top left corner of the screen. This section is divided into three categories:

- 1 **Alarms** – Displays critical alerts that require immediate attention.
- 2 **Notifications** – Shows general system messages and updates.
- 3 **History** – Allows you to view all past alarms and notifications for reference.

Within each section, you can choose to dismiss the alarm, view more details, or click the pin icon to see the exact location of the event on the map.

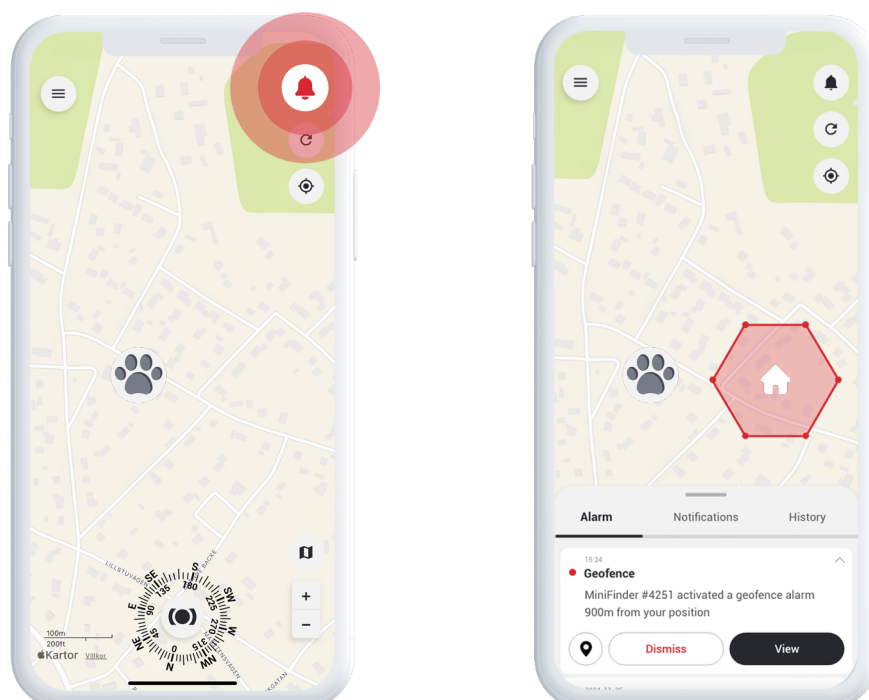

Creating a Geofence

To create a geofence, open the **Geofence** from the quick menu. Choose whether to draw your own geofence using a polygon or a circle.

If you select polygon, mark the desired area by placing and connecting points on the map. Then, select the device you want to link to the geofence and define whether alerts should trigger when the device enters, exits, or both.

Finally, give your geofence a name, choose a color, and **click on Save**.

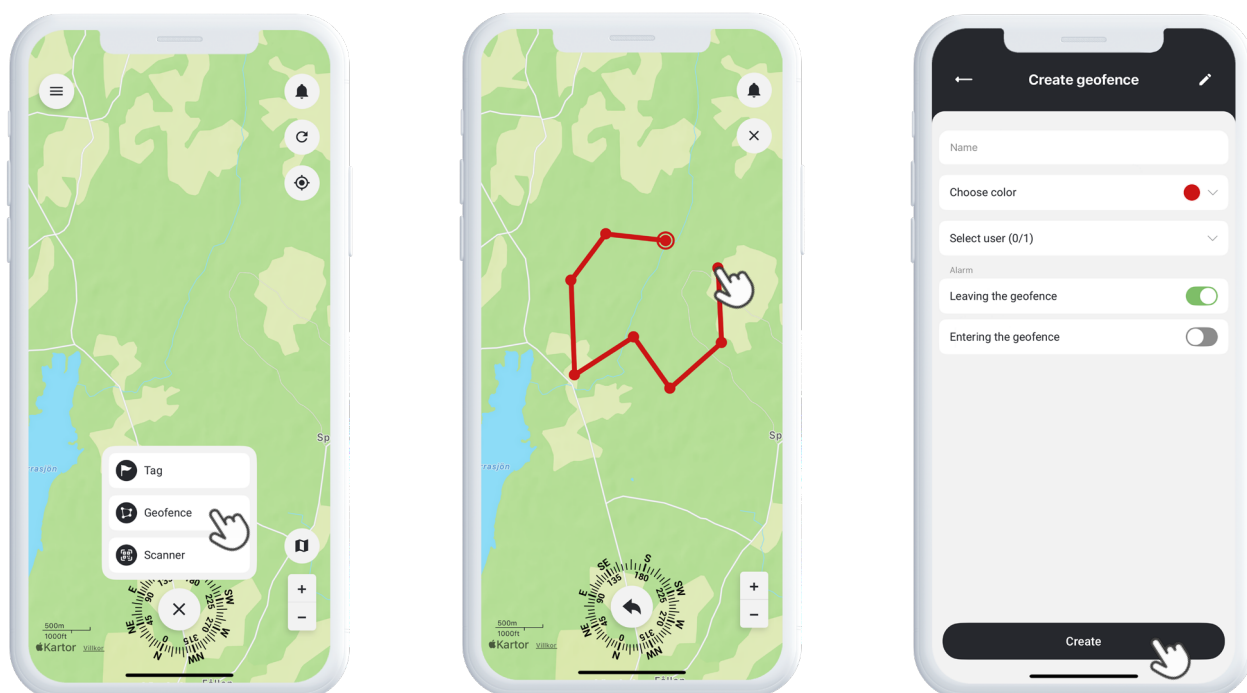

Tags

Tags allow you to highlight specific locations on the map that are important for your tracking setup.

To create a tag, **select Tags** in the quick menu and move the pointer to the desired location on the map. Choose the type of tag, add a label, and include any additional information if needed. Click **Save**, and the tag will instantly appear on the map.

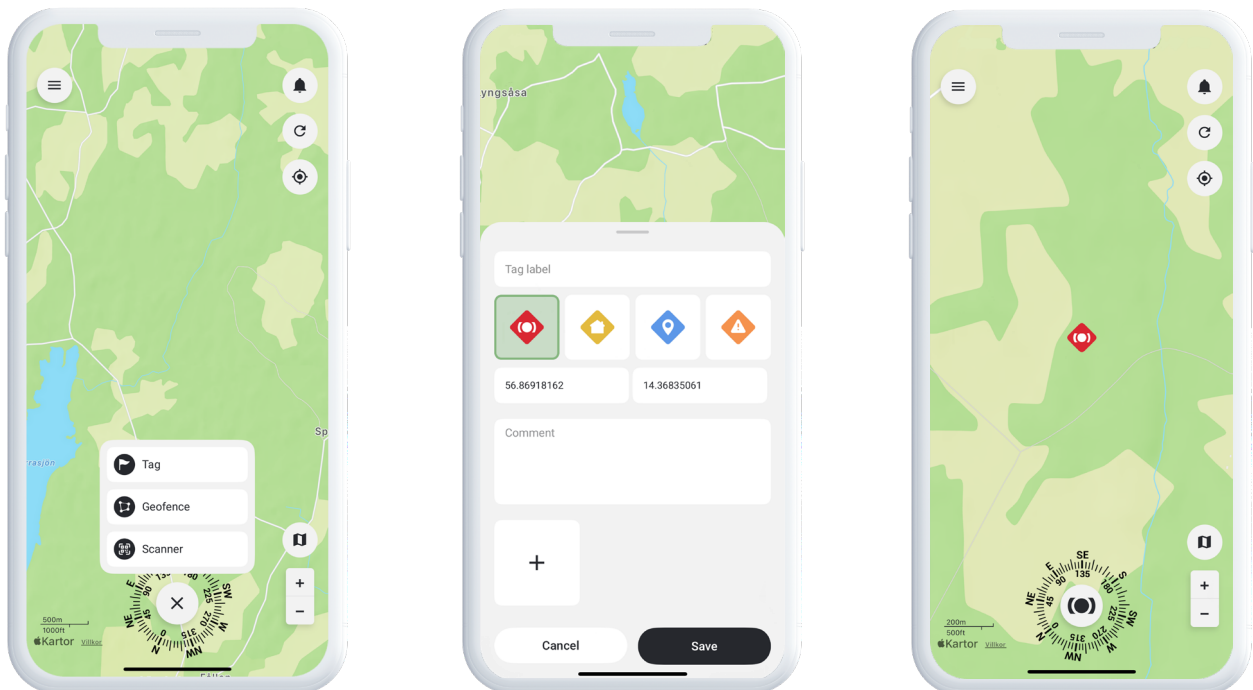

Reminder

MiniFinder Live includes a built-in calendar feature to help you stay organized.

To create a reminder, **click on the menu** and select **Reminder**. From here, you can schedule events such as vet appointments, feeding times, or any other important tasks related to your animal.

Choose the date, set how often the reminder should repeat, and click **Save**.

Your reminder will now appear in the calendar, helping you keep track of key activities with ease.

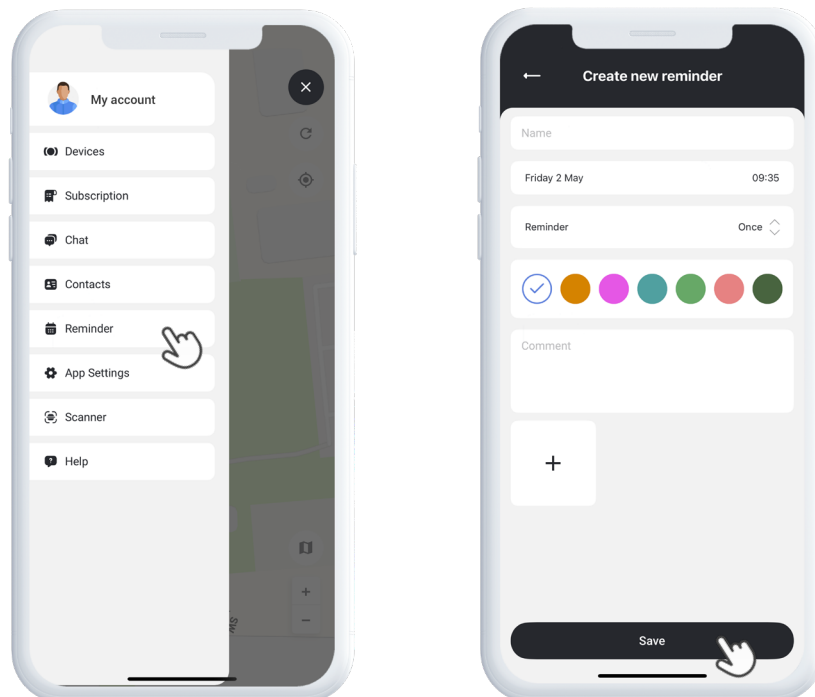

Need More Help?

For support and feature documentation, go to the **Help** section in the main menu. There you'll find step-by-step guides covering key MiniFinder Live functions, designed to help you maximize the platform's capabilities.

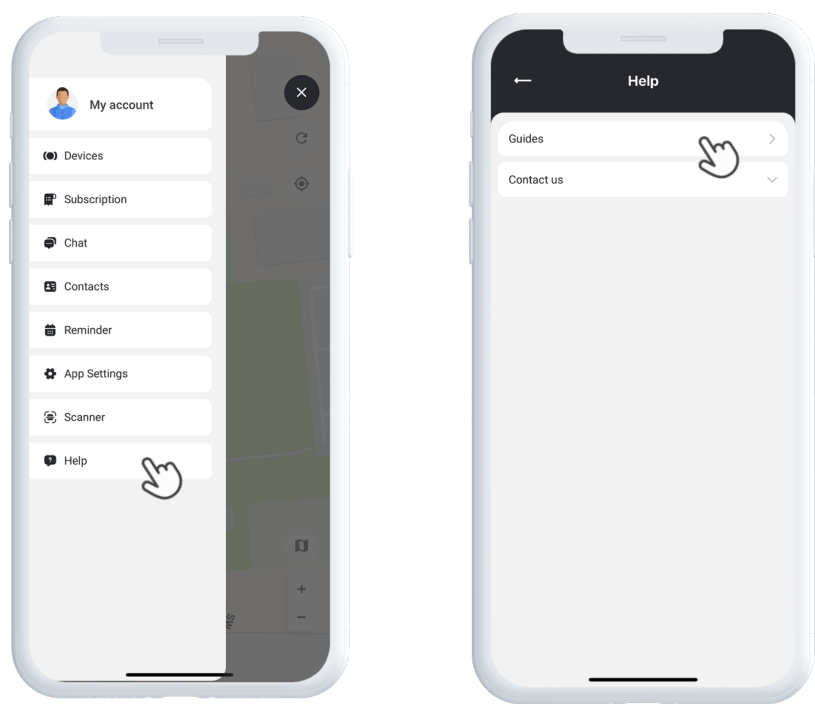

Specifications

Dimensions	65 mm x 35 mm x 16 mm
Weight	39g
Battery Life	35h with 5 minutes interval
Connectivity	LTE: M1, NB2, GSM: 850/900/1800/1900 MHz
Power Source	5V DC
Operating Temperature	-20°C ~ +60°C
GPS Start Time	Active 1s, Hot 2s, Cold 26s
Waterproof	Yes, IP67 certified
Memory	1 Mb (flash memory)
LED	3 LED lamps indicate GPS, LTE and Power

Memory

The device is equipped with a built-in 1 MB flash memory. This memory stores GPS data when GSM network coverage is unavailable (e.g., in rural areas, indoors, underground locations, etc.). The stored location data is automatically transmitted as soon as GSM coverage is restored.

Safety Declaration

This equipment has been tested and found to comply with safety certification requirements according to the specifications of EN Standard: EN60950-1: 2006 + A12: 2011.

Important Safety Instructions

Read these instructions carefully.

Keep these instructions for future reference.

Heed all warnings.

Follow all instructions.

Do not tamper with your MiniFinder®.

Do not use abrasive cleaners to clean your MiniFinder®.

Do not place your MiniFinder® in a dishwasher, washing machine, or dryer.

Do not expose your MiniFinder® to extremely high or low temperatures.

Do not use your MiniFinder® in a sauna or steam room.

Do not leave your MiniFinder® in direct sunlight for extended periods.

Do not place your MiniFinder® near an open flame.

Do not attempt to disassemble your MiniFinder®; it contains no user-serviceable parts.

Recycling Information

The symbol on the product or its packaging indicates that this product must be disposed of separately from household waste at the end of its service life. Please be aware that it is your responsibility to dispose of electronic equipment properly at designated recycling centers, in order to help conserve natural resources.