

MiniFinder® Watch

User Manual



Table of Contents

MiniFinder Watch

<u>Introduction</u>	3
<u>Package Contents</u>	3
<u>Management</u>	3
<u>Overview</u>	4
<u>Get started</u>	4
<u>Explanation Of Voice Notifications</u>	5
<u>Functions & Settings</u>	6
<u>Activate SOS-Alarm</u>	7
<u>Cancel SOS-Alarm</u>	7
<u>Voicemail</u>	8
<u>Fall Alarm</u>	9

MiniFinder Live - Alarm Management System

MiniFinder Live App	10
Overview	11
Charging Dock as a Beacon	12
Menu	13
Add a new device	15
Device List	16
Device Panel & Settings	20
Call the Device	21
Alarm	22
Create a Geofence	23
Tags	24
Add a Contact	26
Share a Location with a Contact	27
Reminders	28
Help	29

Introduction

This user manual is intended for you who are using MiniFinder Watch. The manual contains information about installation, features and how to use the watch in your daily life.

All necessary information is included in this manual, making it easy to get started and make the most of your safety watch.

Package Contents

1 MiniFinder Watch

2 Charging Pad

3 USB Charging Cable

4 Wall Charger



Overview

MiniFinder Watch is a modern safety watch designed to increase security and peace of mind in everyday life.

Please read this guide before you start using the device.



Management

1 Charge Before First Use

Charge the device for at least 3 hours before using it for the first time.

2 Charge the Device

To charge the device, place the magnetic charging pad on the back of the unit.

3 While Charging

During charging, the current battery percentage is displayed on the screen.

4 Power On the Device

To turn on the device, press and hold the front button until the MiniFinder logo appears.

5 Power Off the Device

To turn off the device, go to Settings > System > Power Off.

Note that the device cannot be turned off while it is charging.

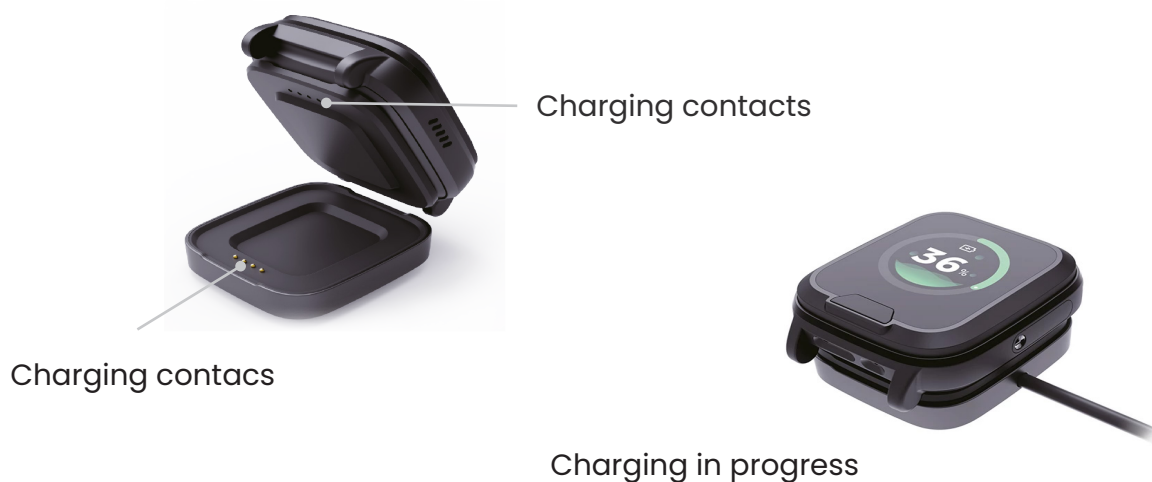

Explanation of Voice Messages

MiniFinder Watch can provide voice messages with information, such as charging status or different operating modes. The function is disabled by default, but the speaker volume and voice messages can be activated or adjusted in the app.

- A The battery in your MiniFinder is charging.**
Your MiniFinder Watch is connected to a power source and is currently charging.
- B The battery in your MiniFinder is low. Connect the charger**
The battery level of your MiniFinder is low and should be charged. The message will repeat three times.
- C Your SOS alarm has been activated. Press the alarm button to cancel.**
The SOS alarm has been triggered. Press the alarm button to cancel the alarm before the call starts.
- D Your fall alarm has been activated. Press the alarm button to cancel.**
The fall alarm on your MiniFinder Watch has been activated. Press the alarm button to cancel the alarm.
- E Calling contact number...**
The device calls the preset emergency contacts in the order they are listed in the app. If the first emergency contact does not answer, the device will automatically proceed to the next contact in the list.

Functions & Settings

When MiniFinder Watch is turned on, swipe left or right to navigate through all available functions, such as the heart rate monitor, contacts, step counter and more.

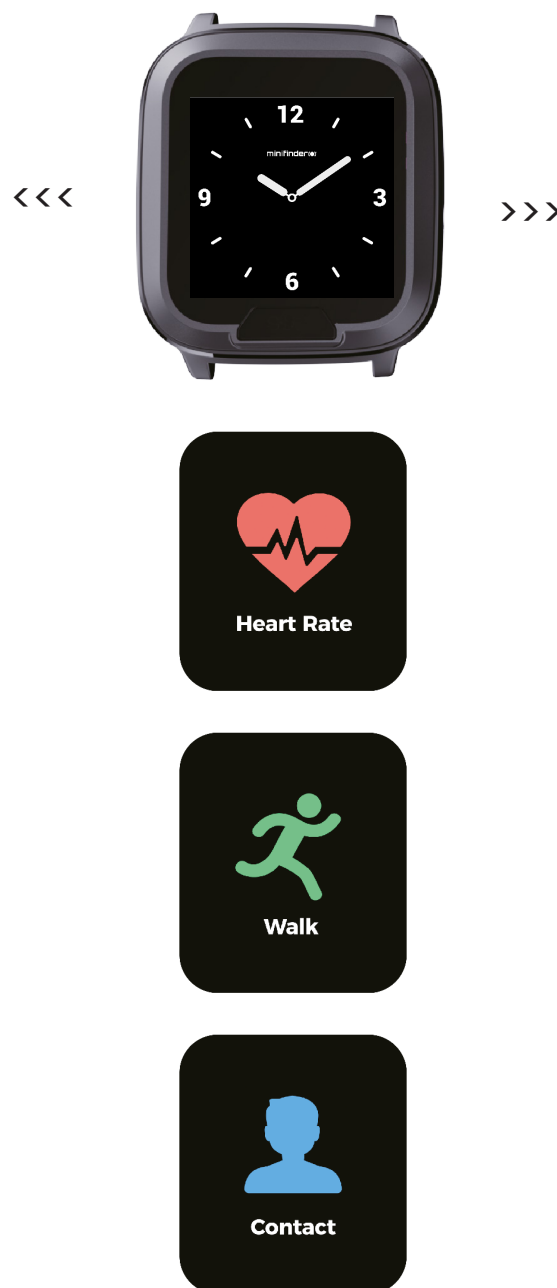

Activate SOS Alarm

Press and hold the alarm button for 3 seconds. The device will vibrate and display the SOS alarm status on the screen. The device will then play a voice message:

“Your alarm has been activated”

The message is repeated three times. If the alarm is not canceled, the device will start calling the first preset contact.

Cancel SOS Alarm

The alarm can be canceled while the voice message is being played by pressing Cancel. If the alarm is not canceled, the device will continue to call the preset emergency contacts in the specified order. Once the calling sequence has started, the alarm cannot be canceled by default.



Voicemail

We recommend that emergency contacts disable voicemail on their phone to avoid delays in receiving help. The following safety measures apply if the call is redirected to voicemail:

- A The user can end the ongoing call by pressing the SOS button, and the calling sequence will continue if the voicemail does not automatically end the call.
- B An emergency contact can call back the MiniFinder Watch if the call is interrupted. Please note that the watch may continue calling the next contact if the alert sequence has not been stopped.



Fall Alarm

MiniFinder Watch can automatically detect a fall. When this occurs, the watch displays a warning message to the user.

While the voice message is being played, the user can cancel the alarm by pressing Cancel. If the alarm is not canceled within the preset time period, the device will call the emergency contacts.



Introduction to MiniFinder Live

To start using your **MiniFinder Watch**, you need access to **MiniFinder Live**. The service is used through the mobile app, which is available for download on **Google Play** or the **App Store**.



MiniFinder Live is a user-friendly system that gives you access to real-time location, smart alerts and features that increase safety in everyday life. Together with your **MiniFinder Watch**, you get a clear overview of alerts, notifications and important information directly in your mobile.

All users should create their own account with unique login details. One person registers the watch on their account and can then share access with other contacts if needed. Having separate accounts is important to ensure that alert notifications work correctly and reach the right person.

This manual guides you step by step on how to use **MiniFinder Live** and helps you get started in a simple and efficient way.

App Overview

Once the app is installed, the first step is to create an account. Tap **Sign Up**, then enter your email address and create a password to get started.

Once logged in, you'll be presented with an app overview, which is displayed on the right-hand side.



Charging Dock as a Beacon

When you use the charging dock as a Beacon, it acts as a fixed reference point indoors. This improves positioning accuracy when the signal is weak, while also allowing the device to operate more energy efficiently.

- 1 Start the registration**

Make sure the watch is turned on. After registering your account, you can choose to use the charging dock as a Beacon. Note that the charging dock must be connected to a wall outlet. If you select No, the registration will be completed and you can start using the watch as usual.
- 2 Name the location**

Enter a name for the location where the charging dock will be used, for example "Home".
- 3 Scan the QR code**

Scan the QR code located on the back of the charging dock.
- 4 Confirm position**

The app will suggest a location. If it is correct, tap Yes to save and complete the setup. If not, tap No to continue.
- 5 Adjust position manually**

Follow the instructions in the app, select the correct location on the map, and tap Save. The setup is now complete.

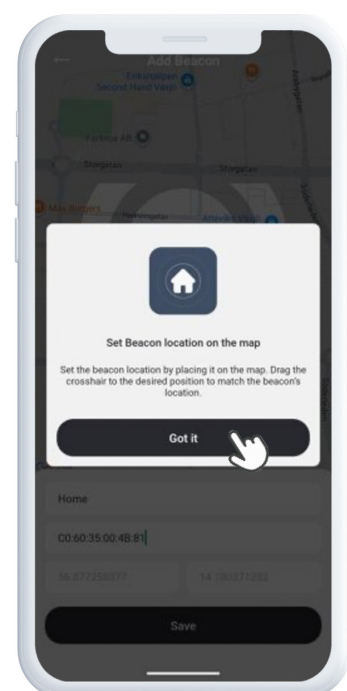
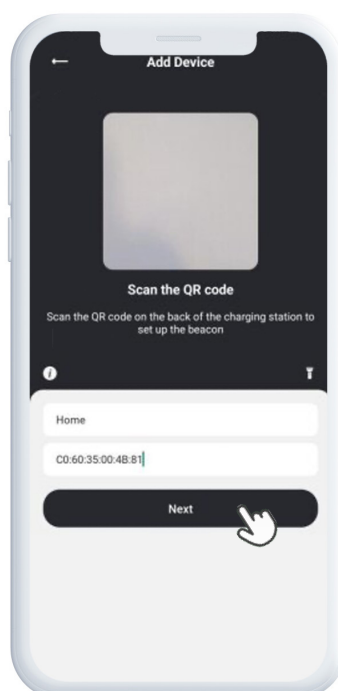
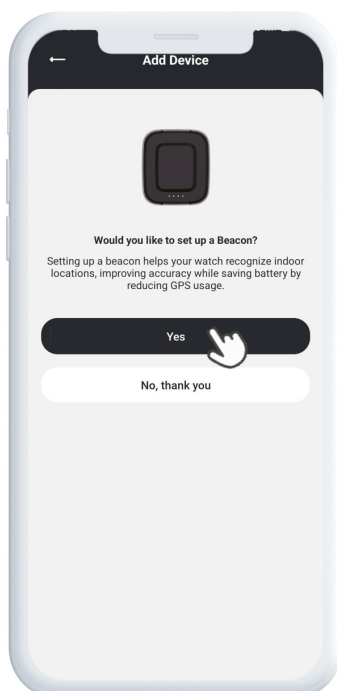

Menu

To open the **quick menu**, tap the MiniFinder button. This gives you fast access to key features like Tags and Geofence.

For additional options, use the **main menu** located in the top left corner of the screen. By tapping this menu, you can access your profile, devices, contacts, reminders, and more.

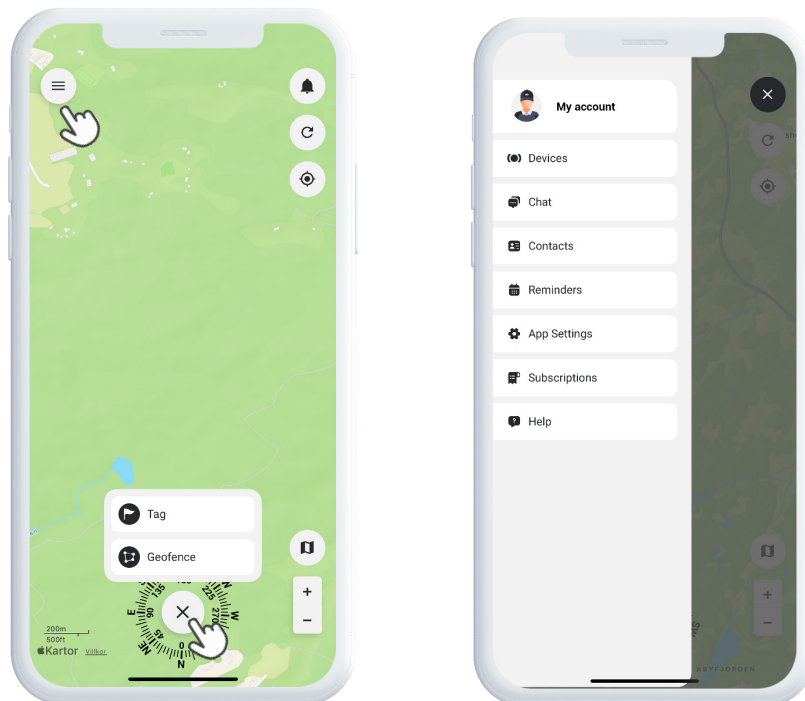

Add a New Device

To add a new device to your account, open the menu in the top left corner of the screen and select **Devices**. Then, tap the **plus icon**. You will now be prompted to choose the type of device you want to add. Once you have made your selection, the app will automatically search for nearby devices.

Make sure the device is powered on and that Bluetooth is enabled on your phone to ensure a smooth setup process.

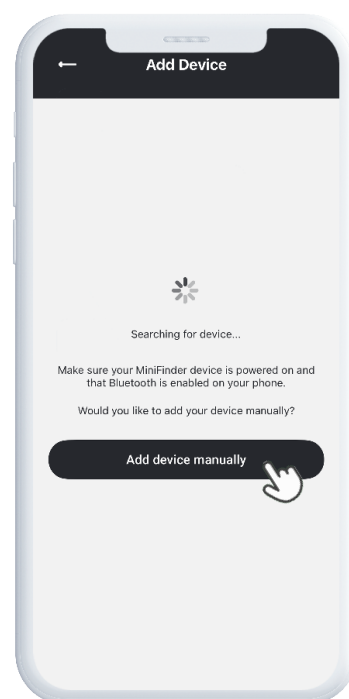
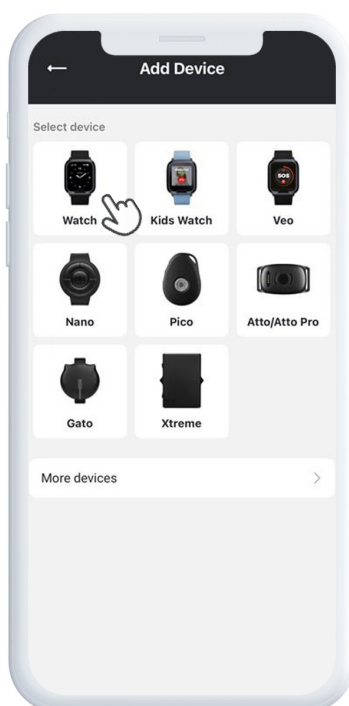
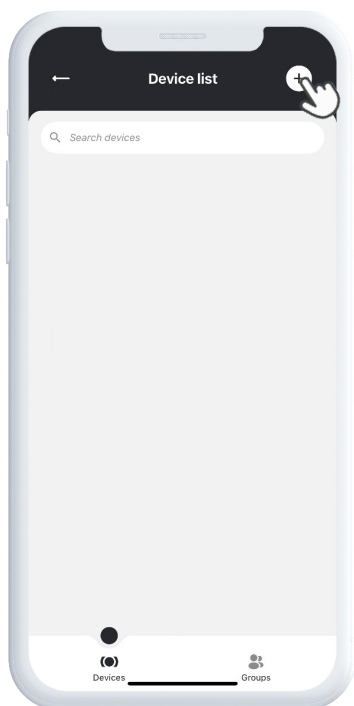

You will now be presented with a suggested device. Verify that the last four digits displayed on the screen (#XXXX) match the last four digits of the IMEI number on the product packaging. If the numbers match, tap Yes. If not, choose to add the device manually. You can do this easily by either entering the IMEI code manually or scanning the barcode on the packaging.

Finally, choose a name for your MiniFinder and tap **Add Device**.

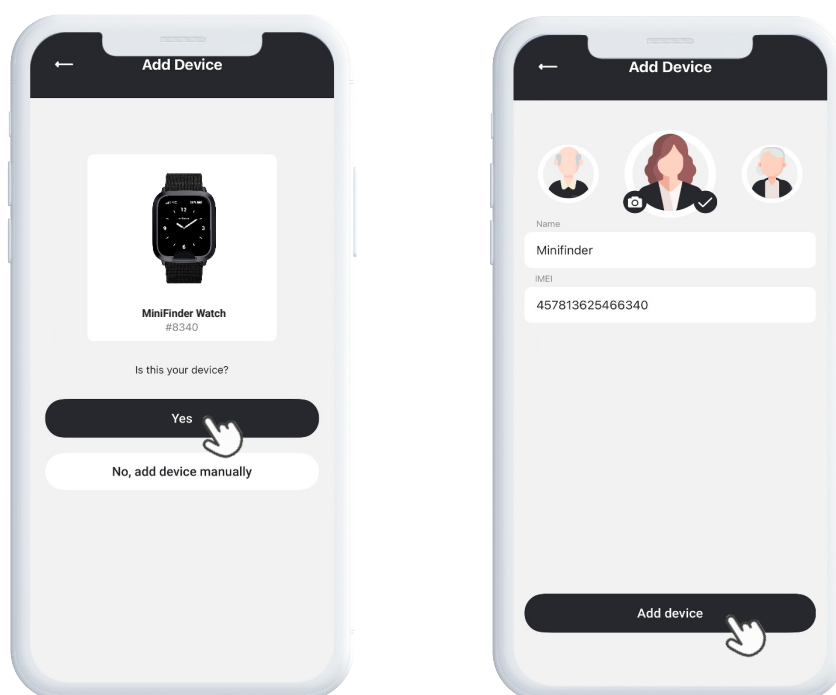

Device List

You can now find your device in the Device List, located under **Devices** in the main menu.

Tap the arrow on the right of your device to expand the drop-down menu, where you can access various options, such as:

- A Show on Map** – View your device’s current location
- B Device Settings** – Adjust positioning and alert preferences
- C Profile** – Edit device information
- D Log** – View event history
- E Comments** – Add notes related to the device

These tools help you manage and monitor your device with ease.

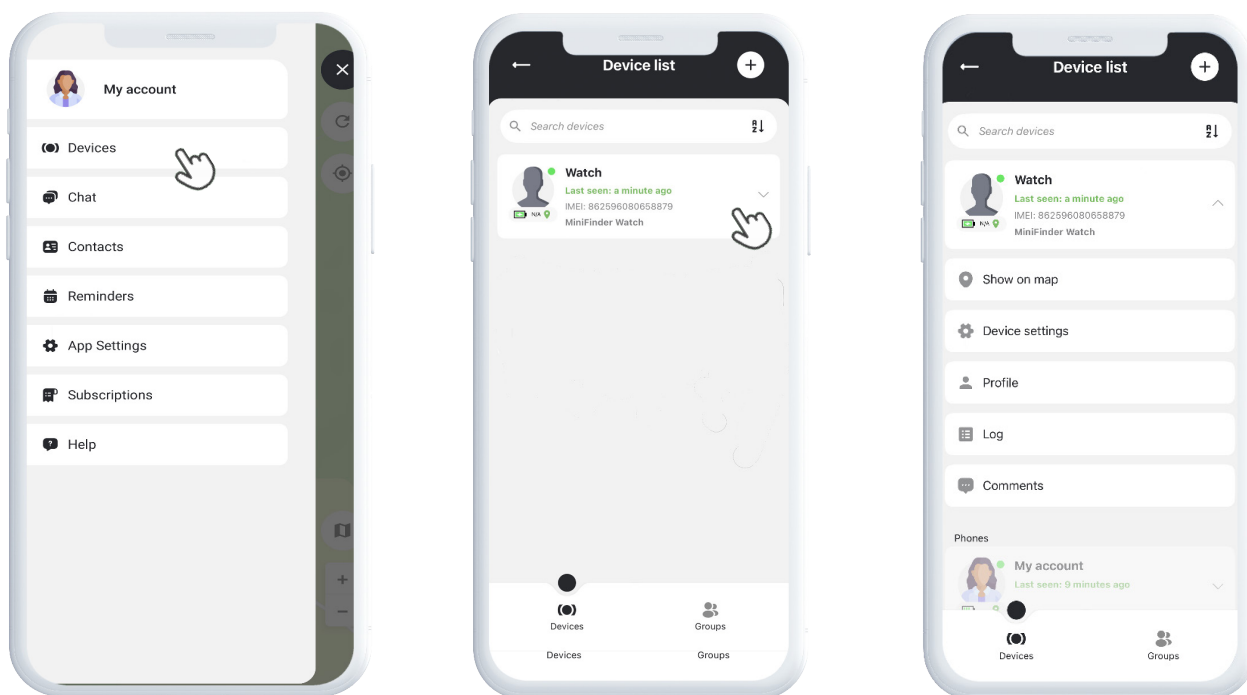

Device Panel & Settings

The **Device Panel** provides valuable insights into the device's location history and movement patterns, giving you a clearer overview of activity over time.

To open the Device Panel, simply tap the **device icon** directly on the map. This will open a detailed view with data such as recent routes, timestamps, and other important metrics.

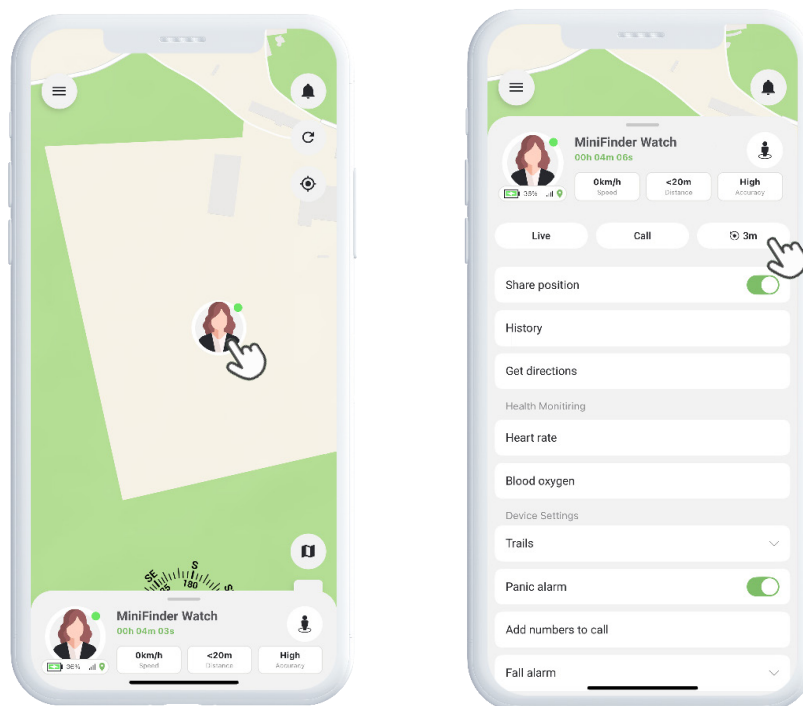

Update Interval

Here you can choose how often the device should send its location to the app. A shorter interval means more frequent updates and more accurate real-time tracking, but it may also consume more battery. A longer interval saves battery but provides location updates less frequently.

Next to the update interval setting, you will find the Live Tracking option. When this mode is activated, the device updates its location every 10 seconds for a 10-minute period. This makes it possible to follow movements in real time for a limited duration, for example when extra accuracy is needed. When live tracking is active, a green indicator will appear to the left of the Live button.

Share position

Share Position



When Share position is enabled, the device's position is shared with the contacts you have previously selected. If you turn it off, the device immediately stops sharing its position with all contacts, without requiring you to change each contact manually.

Street View



In the upper-right corner of the panel, you will find a Street View icon. When you click it, a view opens showing the surroundings of the device's current location. This allows you to easily see what the area looks like in reality, directly on the map.

History

History

In this view, you can select specific dates to see where the device has been. By following the history, you can retrace movement patterns and view the device's positions step by step for the chosen period.

For a clearer overview, the heatmap highlights the places where the device has been most frequently. The color scale ranges from light to dark, with red marking the most frequently visited locations. This makes it easy to quickly identify areas where the device regularly spends time.

Trails

Trails



Here you can set how long the device's movement trail should be displayed on the map, for example 10 minutes, 30 minutes or another time period. You can also choose the color of the trail to make it easier to distinguish from other devices or previous routes.

Alarms

Fall alarm



Panic alarm



In this view, you can manage the device's various alarm functions. The panic alarm activates the large SOS button on the MiniFinder Watch. By enabling the panic alarm and linking phone numbers for the device to call, the wearer can press and hold the button to quickly call selected contacts in an emergency.

You can also activate the fall alarm and low battery warning. Start by turning on the alarms you wish to use, then adjust their sensitivity. The scale ranges from 1 to 9, where 1 means low sensitivity and 9 means very high sensitivity. This way, you can customize the alarms to your needs and always be sure to receive reliable warnings at the right time.

Get direction

Get Directions

By pressing this function, you will receive directions showing how to get to the device's current location. This makes it easy to quickly find your way, whether you are walking, cycling or driving.

Health Monitoring: Heart Rate

MiniFinder Watch is equipped with features for measuring heart rate. By activating heart rate monitoring, you get a continuous overview of your health status.

All measurement data is automatically collected and clearly presented in the app. There, you can easily track changes over time, view graphs and trends, and get a quick overview of current values. This makes it simple to monitor your health in everyday life and take action if anything deviates from normal.

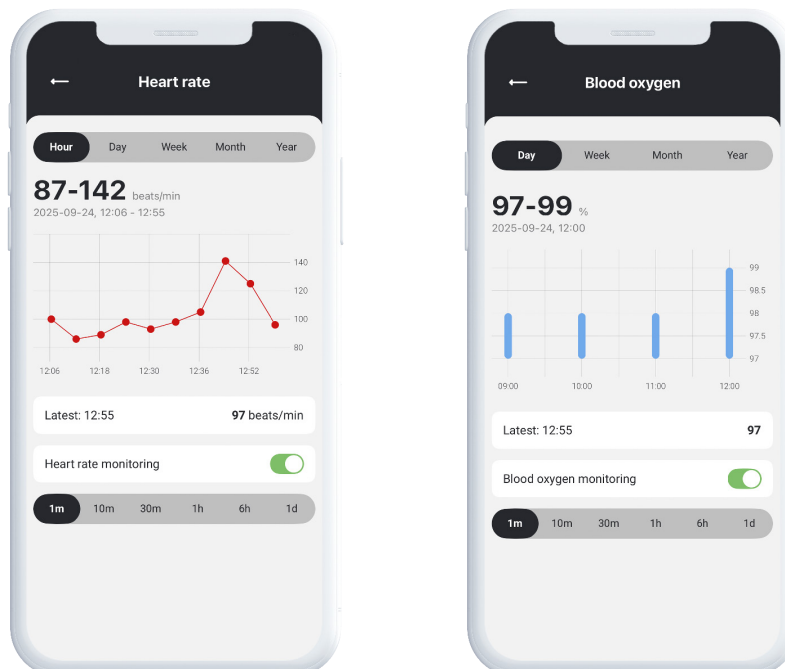

Add numbers to call

In this view, you can add the phone numbers that the device will automatically call in the event of an alarm. These numbers act as preset recipients, ensuring that help can be reached quickly when needed.

Volume

- A Speaker Volume** = Adjusts the volume of the built-in voice in the MiniFinder Veo, which communicates system messages, alarms, and similar notifications. Please note that if you turn off the speaker volume, the device will also be silent during alarms, so-called silent alarms.

- B Call Volume** = Allows you to adjust the volume during calls, making it easier to hear the person on the other end.

- C Ringtone Volume** = Just like a mobile phone, the MiniFinder Watch rings when someone calls it. You can change the ringtone volume by adjusting the corresponding slider.

Beacons

Set up beacons

Beacons are used to improve positioning when the device is indoors. GPS signals can sometimes be less accurate indoors, which may result in a less precise location. The device continuously scans for nearby Beacons. When a Beacon is detected, the device can associate its position with a predefined location on the map. This allows the device to report a more reliable position even when indoors.

Power Saving Zones

Set up power saving zones

By connecting your MiniFinder to your WiFi network and associating the network with its location on the map, a Power Saving Zone is created. Power Saving Zones extend battery life while keeping the device connected and ready to use when it leaves your WiFi network. Similar to Beacons, Power Saving Zones also improve indoor positioning accuracy.

Restart

Restart

By selecting this function, you restart the device. This can be useful if the device is not responding as expected or if you want to perform a quick restart to restore normal operation.

Call the Device

To call your MiniFinder, tap the **device icon** directly on the map to open the Device Panel. Then, press **Call** to start the call.

Please note that in some cases your MiniFinder may have an international phone number. This is because the device is designed to roam freely on the best available mobile network, regardless of its location. Therefore, check with your mobile operator to confirm the applicable rates for calls to international numbers, so you are aware of any potential charges.

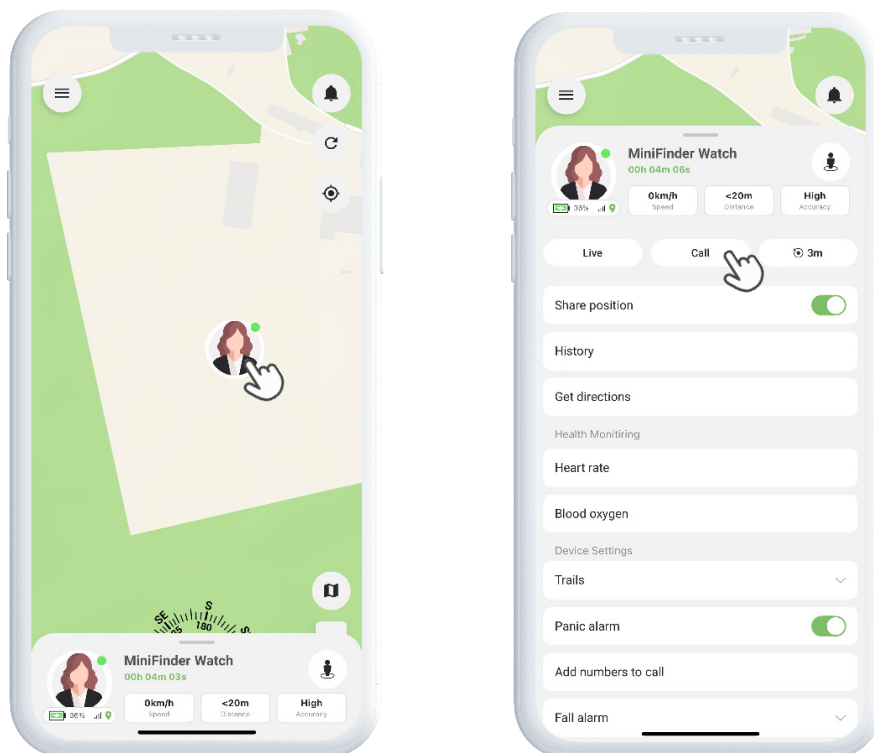

Alarm Notifications

To access your alarm notifications, tap the blinking bell icon located in the top right corner of the screen. This section is divided into three categories:

- 1 **Alarms** – Displays critical alerts that require immediate attention
- 2 **Notifications** – Shows general system messages and updates
- 3 **History** – Allows you to view all past alarms and notifications for reference

Within each category, you can dismiss an alarm to turn it off, view more information, or tap the pin icon to see the exact location on the map. If you are sharing your MiniFinder’s location with someone, it is also recommended to click **Acknowledge/Resolve**, so that they can see that the alarm has been handled.

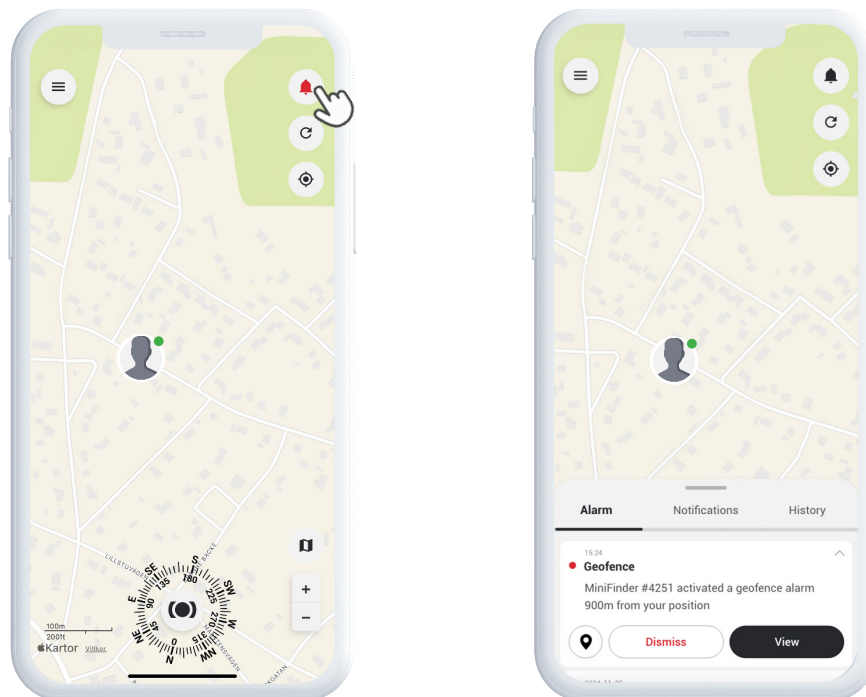

Alarm Management

If multiple numbers are added to the device, it is important that the person answering the call presses **1** on their keypad to confirm the call. If this is not done, the device will continue calling the next number in the list until someone confirms.

Creating a Geofence

To create a geofence, open the **Geofence** option from the quick menu. Choose whether to draw your own geofence using a polygon or a circle.

If you select polygon, mark the desired area by placing and connecting points on the map. Then, select the device you want to link to the geofence and define whether alerts should trigger when the device enters, exits, or both.

Finally, give your geofence a name, choose a color, and **tap Save**.

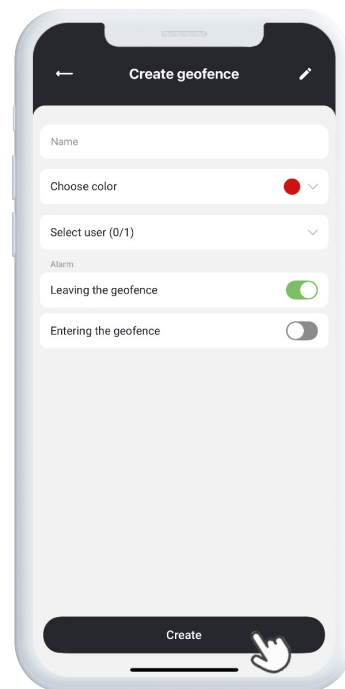
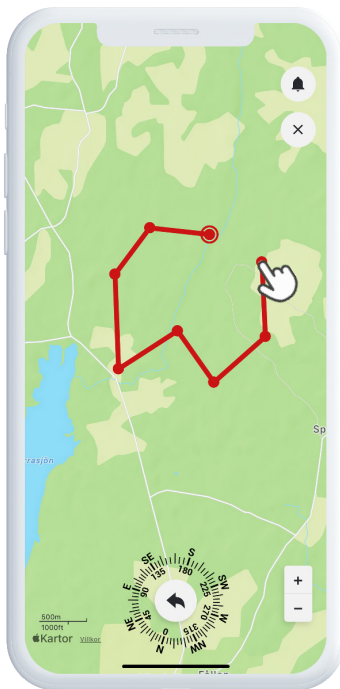
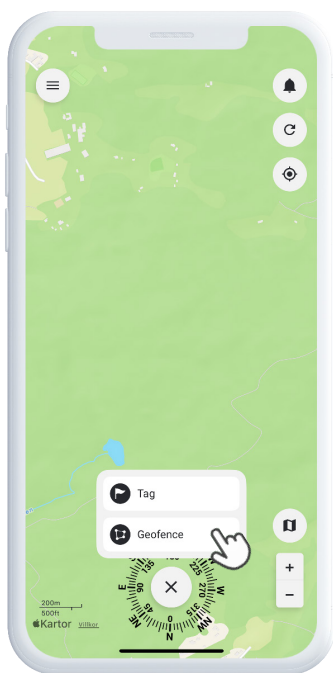

Tags

Tags allow you to highlight specific locations on the map that are important for your tracking setup.

To create a tag, select **Tags** in the quick menu and move the pointer to the desired location on the map. Choose the type of tag, add a label, and include any additional information if needed. Tap **Save**, and the tag will instantly appear on the map.

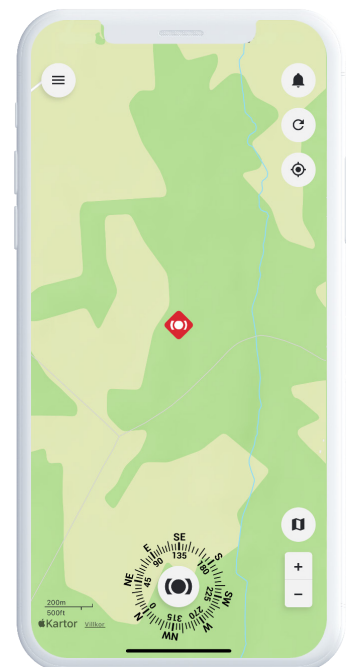
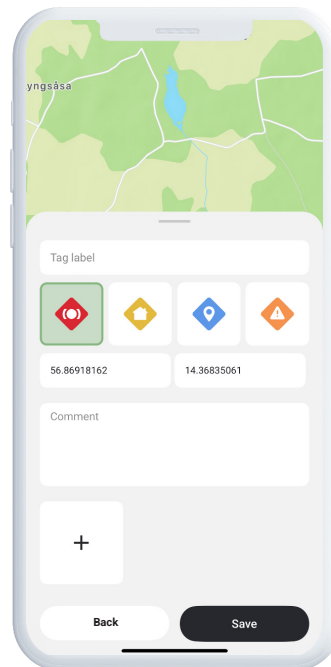
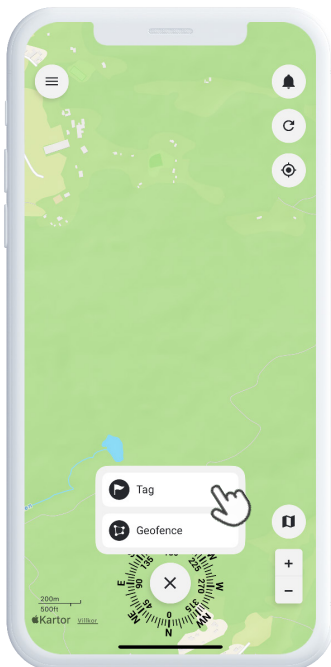

Add a Contact

To share your MiniFinder's location with others, or to view a contact on the map, you must first add each other as contacts in the app.

- 1 Make sure both users have the app open and are logged in.
- 2 Go to the menu and select **Contacts**. Tap the **QR code** icon in the top-right corner.
- 3 The other person opens their **profile** and taps the **QR code** icon in the top-right corner.
- 4 Scan the code – the contact is added instantly.

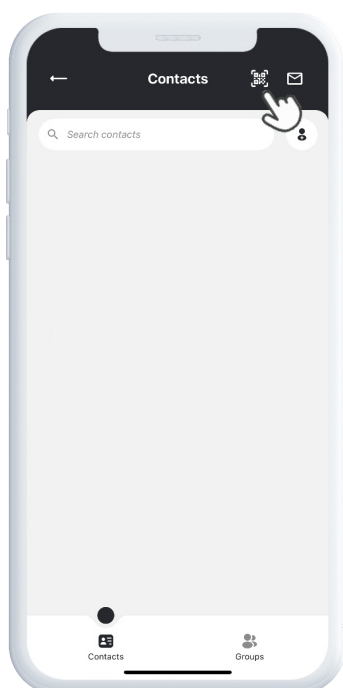
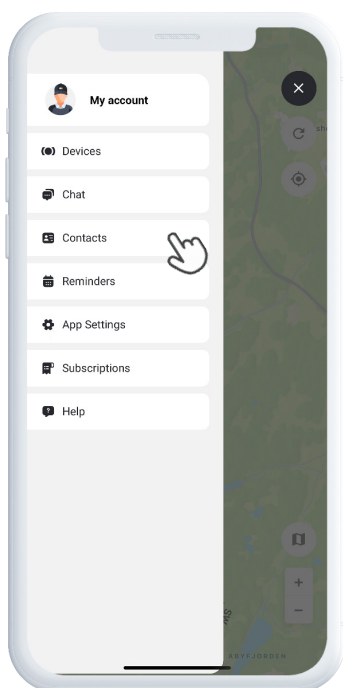

Alternatively, you can add a contact manually:

- 1 Select **Contacts** in the menu.
- 2 Tap the icon to the right of the search bar and enter the person's email address or phone number. Then, tap the magnifying glass to search.
- 3 When the correct contact appears, confirm that you want to add the person. Your contact request will be sent immediately.

Before you can start sharing location or information, the other person must first accept your request.



Share Location with a Contact

Sharing your location with a colleague can increase safety and improve communication. To share your location with a contact in the app, start by tapping the menu in the upper-left corner. Then go to **Contacts** and select the person you want to share your location with.

When the contact is open, choose whether you want to share your own location or the location of a specific device. You can also choose to grant **full access**, which allows the contact to view the device's settings and all available information linked to it. Once you confirm the settings, the location is shared and visible to the recipient.

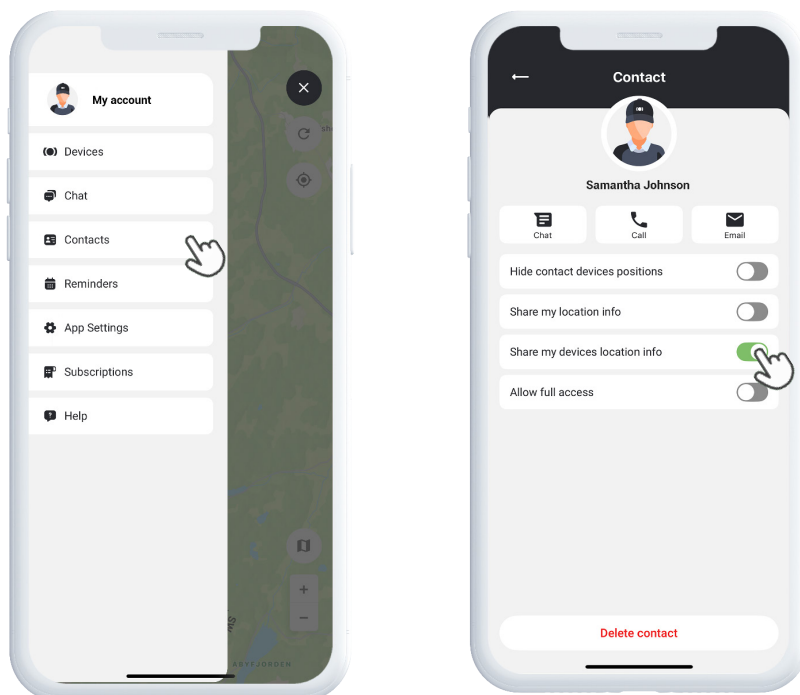

Reminder

MiniFinder Live includes a built-in reminder feature that helps you stay organized.

To create a reminder, tap the menu and select **Reminder**. Here you can schedule important events such as medication reminders, daily routines, or other tasks.

Choose a date and specify how often the reminder should repeat. Then assign it to MiniFinder Watch to receive a notification directly on the watch, and tap **Save**. The reminder will now appear in the calendar, helping you easily keep track of important activities.

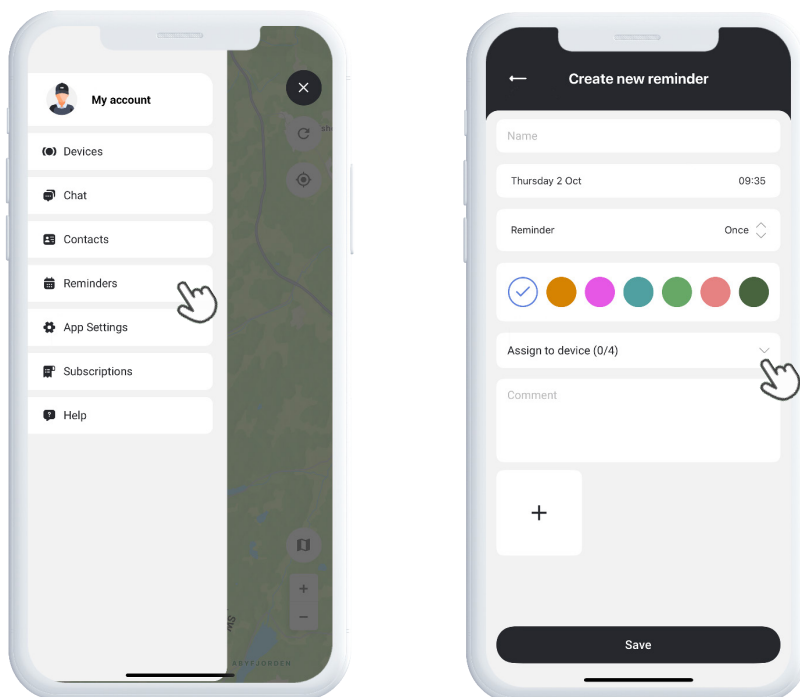

Need More Help?

For support and feature documentation, go to the **Help** section in the main menu. There you will find step-by-step guides and user manuals covering the key features of MiniFinder Live, designed to help you make the most of the platform’s full potential.

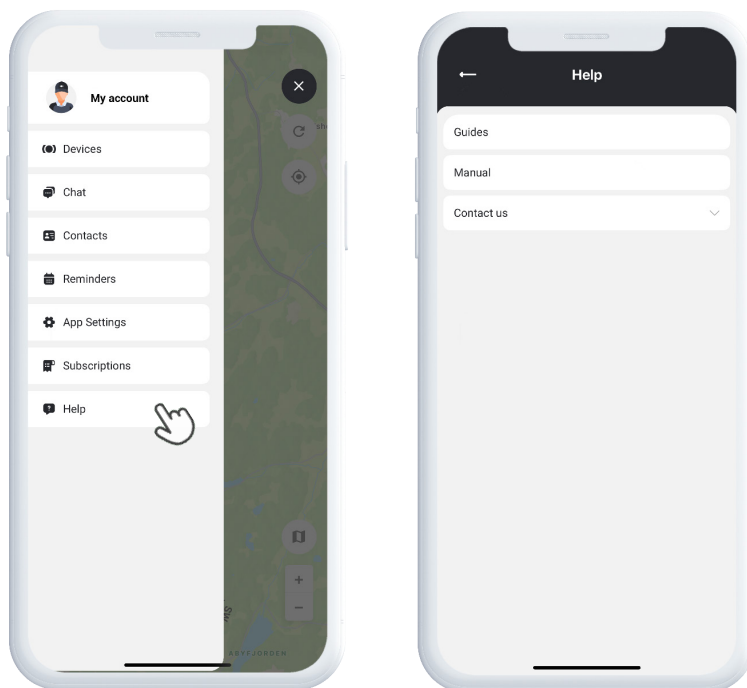

Specifications

Dimensions	47 mm x 42 mm x 15 mm
Weight	38g
Battery Life	48h with 3 minutes interval
Connectivity	LTE/4G (CatM1), GSM
Power Source	5V DC 1.0A
SIM	Preinstalled
Voice call	Yes
Fall sensor	Yes
Screen	1.3" TFT (240 x 240)
GPS	GPS, GLONASS, Galileo

Memory

The device is equipped with a built-in 64 MB flash memory. This memory stores GPS data when GSM network coverage is unavailable (e.g., in rural areas, indoors, underground locations, etc.). The stored location data is automatically transmitted as soon as GSM coverage is restored.

Safety Declaration

This equipment has been tested and found to comply with safety certification requirements according to the specifications of EN Standard: EN60950-1: 2006 + A12: 2011.

Important Safety Instructions

Read these instructions carefully.

Keep these instructions for future reference.

Heed all warnings.

Follow all instructions..

Do not tamper with your MiniFinder®.

Do not use abrasive cleaners to clean your MiniFinder®.

Do not place your MiniFinder® in a dishwasher, washing machine, or dryer.

MiniFinder® should be used within -20°C to +60°C. Outside this range, the device is negatively affected.

Do not use your MiniFinder® in a sauna or steam room.

Do not leave your MiniFinder® in direct sunlight for extended periods.

Do not place your MiniFinder® near an open flame

Do not disassemble your MiniFinder® – it contains no user-serviceable parts.

The warranty will be void if the device is disassembled.

Recycling Information



The symbol on the product or its packaging indicates that this product must be disposed of separately from household waste at the end of its service life. Please be aware that it is your responsibility to dispose of electronic equipment properly at designated recycling centers, in order to help conserve natural resources.